

Inventory of Properties  
Listed on the  
State and National Registers of  
Historical Places

Town of Rochester  
Ulster County, New York

Published by:  
The Rochester Residents Association, Inc.  
October 31, 2002

Table of Contents

Survey of Properties on the  
State and National Register of Historical Places  
in the Town of Rochester, Ulster County, New York  
as of October 31, 2002

|   |    |
|---|----|
| <a href="#">Krom Stone House &amp; Dutch Barn</a> .....           | 3  |
| <a href="#">Sebastian Baker Stone House</a> .....                 | 4  |
| <a href="#">Van Wagenen Stone House &amp; Farm Complex</a> .....  | 5  |
| <a href="#">Jacobus Van Wagenen Stone House</a> .....             | 6  |
| <a href="#">Middaugh Stone House &amp; Dutch Barn</a> .....       | 7  |
| <a href="#">Dirck Westbrook Stone House</a> .....                 | 8  |
| <a href="#">C.K. Schoonmaker Stone House</a> .....                | 9  |
| <a href="#">Davis Stone House</a> .....                           | 10 |
| <a href="#">Johannes Rider Stone House</a> .....                  | 11 |
| <a href="#">Krom Stone House at 31 Upper Whitfield Road</a> ..... | 12 |
| <a href="#">Krom Stone House at 45 Upper Whitfield Road</a> ..... | 13 |
| <a href="#">Hornbeck Stone House</a> .....                        | 14 |
| <a href="#">Ephriam DuPuy Stone House</a> .....                   | 15 |
| <a href="#">Jacob F. Markle Stone House</a> .....                 | 16 |
| <a href="#">Winfield Corners Stone House</a> .....                | 17 |
| <a href="#">Stilwell-Westbrook Stone House</a> .....              | 18 |
| <a href="#">Jacob Hoornbeck Stone House</a> .....                 | 19 |
| <a href="#">Sahler Stone House</a> .....                          | 20 |
| <a href="#">Sahler Stone House &amp; Dutch Barn</a> .....         | 21 |
| <a href="#">Lucas Krom Stone House</a> .....                      | 22 |
| <a href="#">Schoonmaker Stone House &amp; Farm</a> .....          | 23 |
| <a href="#">Zacharia Barley Stone House</a> .....                 | 24 |
| <a href="#">J. Sahler Stone House</a> .....                       | 25 |
| <a href="#">Terwilliger-Smith Farm<sup>1</sup></a> .....          | 26 |
| <a href="#">Stillwell Stone House</a> .....                       | 27 |
| <a href="#">J. DePuy Stone House</a> .....                        | 28 |
| <a href="#">Common School No. 10</a> .....                        | 29 |

Downloadable copies of this report are available free of charge at [www.Accord-Kerhonkson.com](http://www.Accord-Kerhonkson.com)  
The complete National Register of Historical Places is available at  
[www.nationalregisterofhistoricplaces.com/ny/ulster/state.html](http://www.nationalregisterofhistoricplaces.com/ny/ulster/state.html)

All rights reserved  
For more information contact [resident@accord-kerhonkson.com](mailto:resident@accord-kerhonkson.com)

---

<sup>1</sup> Approved for State Listing in September 2002, nominated for National Listing.

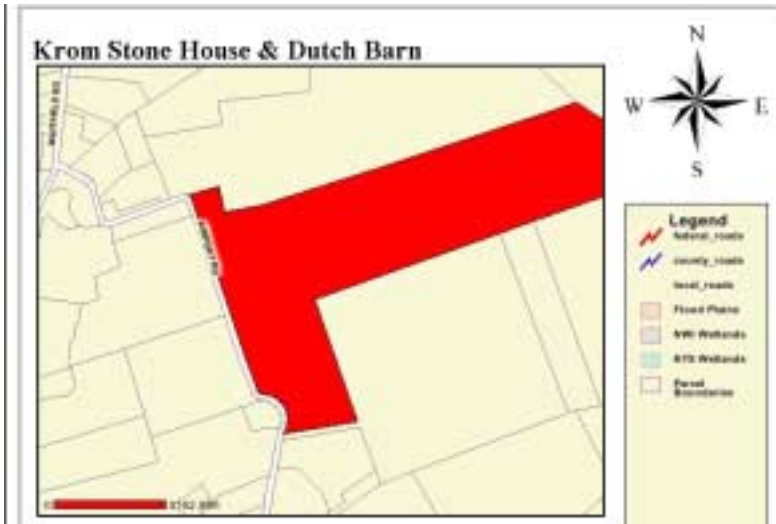

69.3-2-44  
 234 Airport Road  
 92.70 acres

**Krom Stone House and Dutch Barn** (added 1995 - **Building** - #95000955)

Airport Rd., Rochester

|                                  |   |
|----------------------------------|---|
| Historic Significance:           | Architecture/Engineering  |
| Architect, builder, or engineer: | Unknown   |
| Architectural Style:             | No Style Listed   |
| Area of Significance:            | Architecture  |
| Period of Significance:          | 1700-1749, 1750-1799, 1850-1874                                 |
| Owner:                           | <b>Private</b>  |
| Historic Function:               | Agriculture/Subsistence, Domestic                               |
| Historic Sub-function:           | Agricultural Outbuildings, Secondary Structure, Single Dwelling |
| Current Function:                | Domestic  |
| Current Sub-function:            | Secondary Structure, Single Dwelling                            |



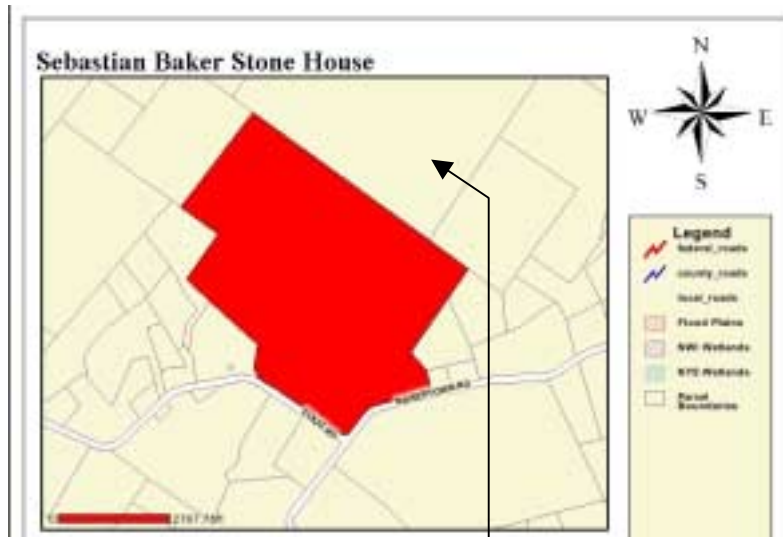

Common Ownership

10 Dug Road  
 68.2-2-44.110 & 68.2-2-45  
 63.10 acres & 100 acres

**Baker, Sebastian, Stone House** (added 1996 - **Building** - #96000136)

10 Dug Rd., Rochester

Historic Significance: Architecture/Engineering

Area of Significance: Architecture

Period of Significance: 1750-1799, 1900-1924

Owner: **Private**

Historic Function: Agriculture/Subsistence, Domestic

Historic Sub-function: Agricultural Outbuildings, Secondary Structure, Single Dwelling

Current Function: Agriculture/Subsistence, Domestic, Funerary

Current Sub-function: Agricultural Outbuildings, Cemetery, Secondary Structure, Single Dwelling



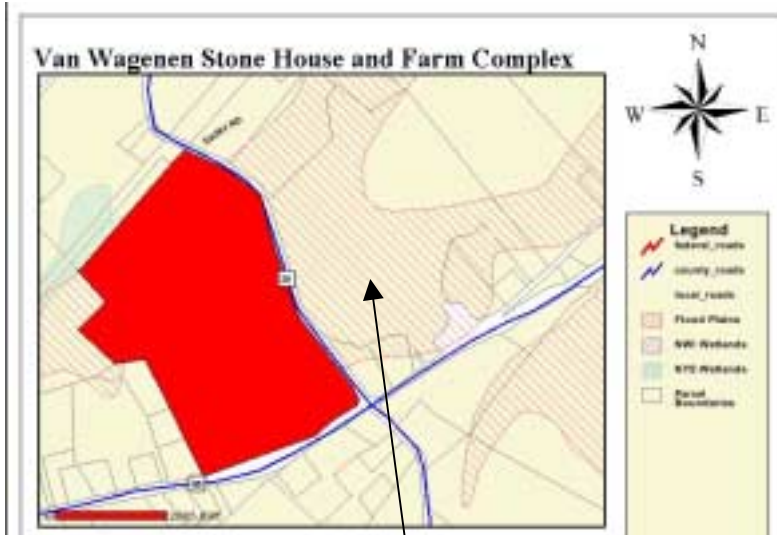

2732 Lucas Turnpike  
 69.4-2-22 & 69.4-2-15  
 70.60 acres & 54.6 acres

Common Ownership

**Van Wagenen Stone House and Farm Complex** (added 1999 - **Building** - #99000994)

Also known as **Het Killities Landt**

2732 Lucas Turnpike, Rochester

|                         |  |
|-------------------------|--|
| Historic Significance:  | Architecture/Engineering   |
| Architectural Style:    | Colonial, Federal  |
| Area of Significance:   | Architecture   |
| Period of Significance: | 1700-1749, 1750-1799, 1800-1824, 1825-1849, 1850-1874, 1875-1899 |
| Owner:                  | <b>Private</b>   |
| Historic Function:      | Agriculture/Subsistence, Domestic                                |
| Historic Sub-function:  | Animal Facility, Single Dwelling, Storage                        |
| Current Function:       | Agriculture/Subsistence, Domestic                                |
| Current Sub-function:   | Animal Facility, Single Dwelling, Storage                        |





2659 Lucas Turnpike  
 69.4-2-17  
 9.30 acres

**Van Wageningen, Jacobus, Stone House** (added 1999 - **Building** - #99000999)

2659 Lucas Turnpike, Rochester

|                         |                          |
|-------------------------|--------------------------|
| Historic Significance:  | Architecture/Engineering |
| Architectural Style:    | Colonial                 |
| Area of Significance:   | Architecture             |
| Period of Significance: | 1750-1799                |
| Owner:                  | <b>Private</b>           |
| Historic Function:      | Domestic                 |
| Historic Sub-function:  | Single Dwelling          |
| Current Function:       | Domestic                 |
| Current Sub-function:   | Single Dwelling          |





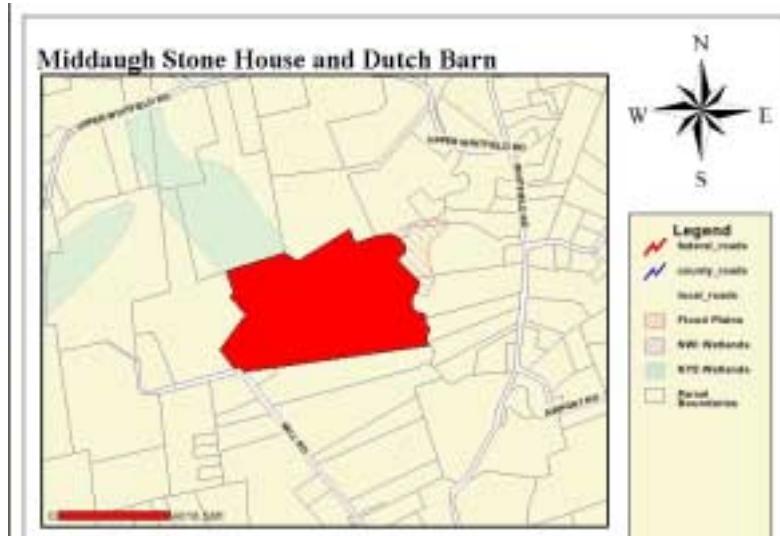

476 Mill Hook Road  
 69.3-1-2.120  
 55.75 acres  
 aka Benjamin Rider House  
 Plus Fields

**Middaugh--Stone House and Dutch Barn** (added 1994 - **Building** - #94001514)

476 Mill Rd., Rochester

|                                  |  |
|----------------------------------|--|
| Historic Significance:           | Architecture/Engineering                             |
| Architect, builder, or engineer: | Unknown  |
| Architectural Style:             | No Style Listed                                      |
| Area of Significance:            | Architecture   |
| Period of Significance:          | 1750-1799, 1875-1899                                 |
| Owner:                           | <b>Private</b>                                       |
| Historic Function:               | Agriculture/Subsistence, Domestic, Funerary          |
| Historic Sub-function:           | Agricultural Outbuildings, Cemetery, Single Dwelling |
| Current Function:                | Agriculture/Subsistence, Domestic, Funerary          |
| <u>Current Sub-function:</u>     | Agricultural Outbuildings, Cemetery, Single Dwelling |

No Photo Available



18 Old Whitfield Rd.  
 69.3-1-24  
 4.50 acres

**Westbrook, Dirck, Stone House** (added 1995 - **Building** - #95000949)

18 Old Whitfield Rd., Rochester

|                                  |                                      |
|----------------------------------|--------------------------------------|
| Historic Significance:           | Architecture/Engineering             |
| Architect, builder, or engineer: | Unknown                              |
| Architectural Style:             | No Style Listed                      |
| Area of Significance:            | Architecture                         |
| Period of Significance:          | 1700-1749, 1850-1874, 1925-1949      |
| Owner:                           | <b>Private</b>                       |
| Historic Function:               | Domestic                             |
| Historic Sub-function:           | Secondary Structure, Single Dwelling |
| Current Function:                | Domestic                             |
| Current Sub-function:            | Secondary Structure, Single Dwelling |





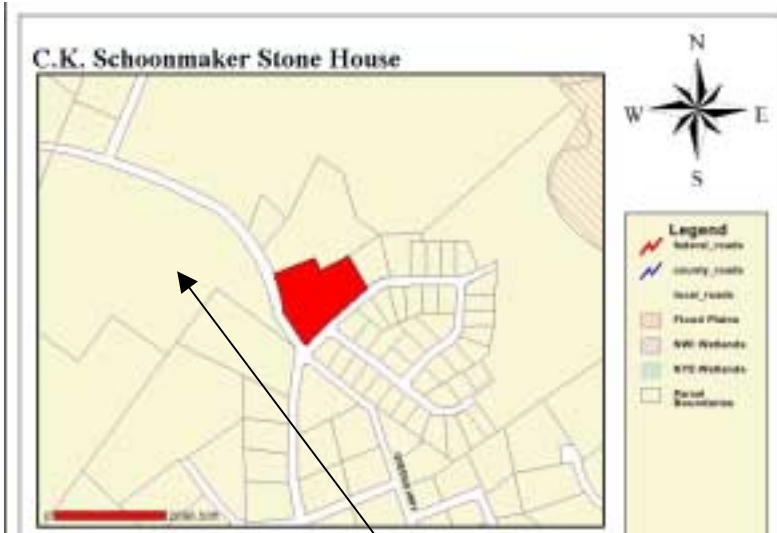

294 Queens Highway  
 68.4-6-21.100 & 64.8-6-1.200  
 4.20 acres & 26.8 acres

Common Ownership

**Schoonmaker, C. K., Stone House** (added 1997 - **Building** - #97000107)

294 Queens Hwy., Rochester

|                         |                          |
|-------------------------|--------------------------|
| Historic Significance:  | Architecture/Engineering |
| Architectural Style:    | No Style Listed          |
| Area of Significance:   | Architecture             |
| Period of Significance: | 1825-1849                |
| Owner:                  | <b>Private</b>           |
| Historic Function:      | Domestic                 |
| Historic Sub-function:  | Single Dwelling          |
| Current Function:       | Domestic                 |
| Current Sub-function:   | Single Dwelling          |



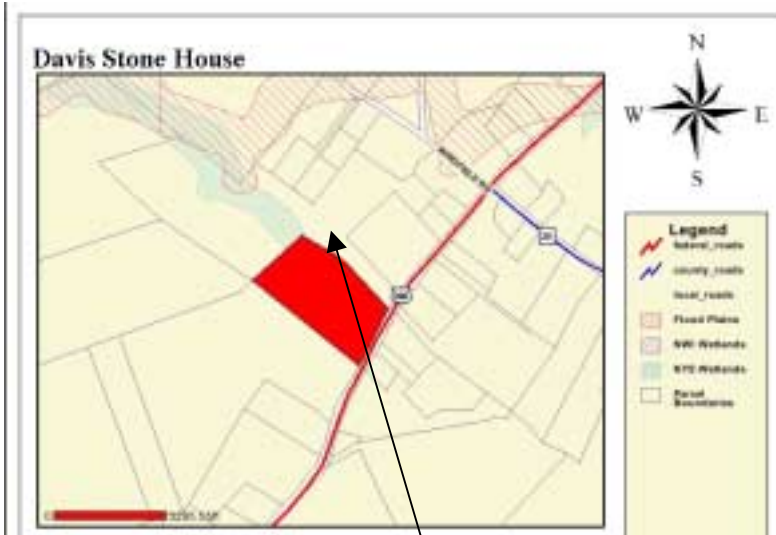

Common Ownership

4652 Route 209  
 69.3-2-10  
 15.50 acres and 69.3-2-3 39.3 acres

**Davis Stone House** (added 1999 - **Building** - #99000995)  
 4652 NY 209, Rochester

|                         |  |
|-------------------------|--|
| Historic Significance:  | Architecture/Engineering   |
| Architectural Style:    | Colonial   |
| Area of Significance:   | Architecture   |
| Period of Significance: | 1750-1799, 1800-1824, 1825-1849, 1850-1874, 1875-1899, 1900-1924 |
| Owner:                  | <b>Private</b>   |
| Historic Function:      | Domestic   |
| Historic Sub-function:  | Single Dwelling  |
| Current Function:       | Domestic   |
| Current Sub-function:   | Single Dwelling  |



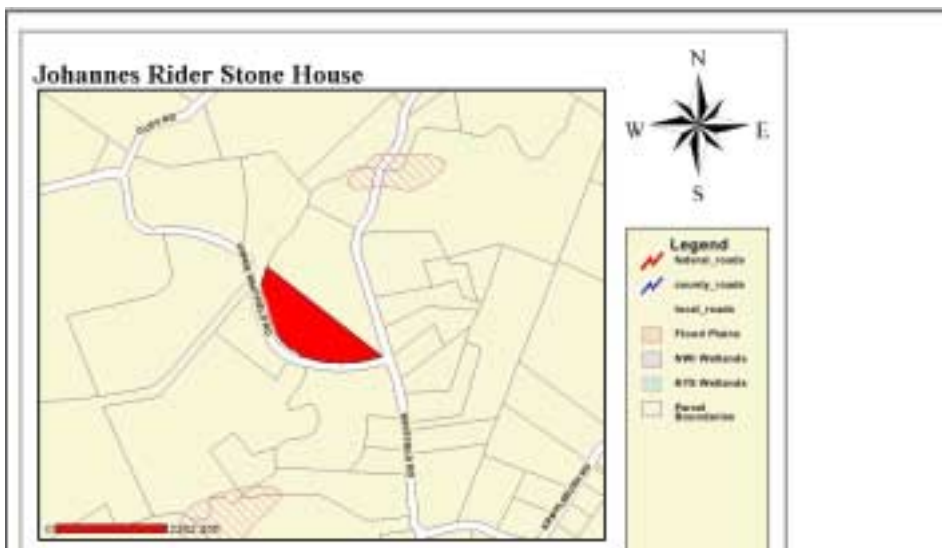

7 Upper Whitfield Road  
 69.1-1-14.200  
 4.65 acres

**Rider, Johannes, Stone House** (added 1995 - **Building** - #95000956)

7 Upper Whitfield Rd., Rochester

|                                  |                                      |
|----------------------------------|--------------------------------------|
| Historic Significance:           | Architecture/Engineering             |
| Architect, builder, or engineer: | Unknown                              |
| Architectural Style:             | No Style Listed                      |
| Area of Significance:            | Architecture                         |
| Period of Significance:          | 1800-1824, 1875-1899                 |
| Owner:                           | <b>Private</b>                       |
| Historic Function:               | Domestic                             |
| Historic Sub-function:           | Secondary Structure, Single Dwelling |
| Current Function:                | Domestic                             |
| Current Sub-function:            | Secondary Structure, Single Dwelling |



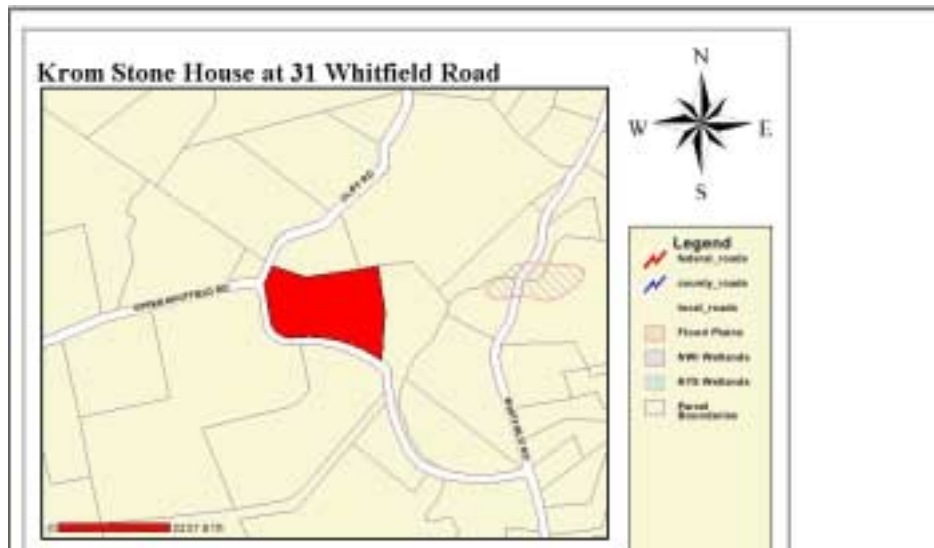

31 Upper Whitfield Rd.  
 69.1-1-23  
 6.90 acres

**Krom Stone House at 31 Upper Whitfield Road** (added 1995 - **Building** - #95000954)

31 Upper Whitfield Rd., Rochester

|                                  |                          |
|----------------------------------|--------------------------|
| Historic Significance:           | Architecture/Engineering |
| Architect, builder, or engineer: | Unknown                  |
| Architectural Style:             | No Style Listed          |
| Area of Significance:            | Architecture             |
| Period of Significance:          | 1750-1799                |
| Owner:                           | <b>Private</b>           |
| Historic Function:               | Domestic                 |
| Historic Sub-function:           | Single Dwelling          |
| Current Function:                | Domestic                 |
| Current Sub-function:            | Single Dwelling          |







45 Upper Whitfield Rd.  
 68.2-2-24  
 8.12 acres

**Krom Stone House at 45 Upper Whitfield Road** (added 1995 - **Building** - #95000950)

45 Upper Whitfield Rd., Rochester

|                                  |                          |
|----------------------------------|--------------------------|
| Historic Significance:           | Architecture/Engineering |
| Architect, builder, or engineer: | Unknown                  |
| Architectural Style:             | No Style Listed          |
| Area of Significance:            | Architecture             |
| Period of Significance:          | 1750-1799, 1875-1899     |
| Owner:                           | <b>Private</b>           |
| Historic Function:               | Domestic                 |
| Historic Sub-function:           | Single Dwelling          |
| Current Function:                | Domestic                 |
| Current Sub-function:            | Single Dwelling          |



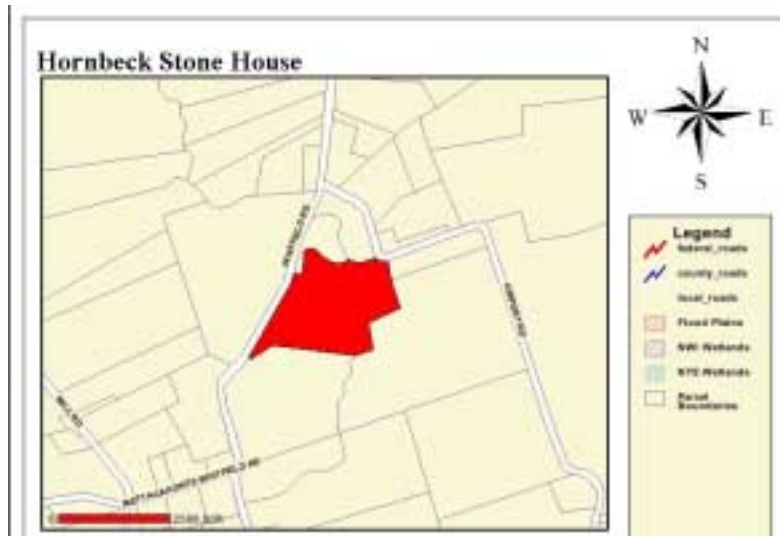

149 Whitfield Road  
 69.3-1-12.110  
 11.3 acres

**Hornbeck Stone House** (added 1995 - **Building** - #95000957)

149 Whitfield Rd., Rochester

|                                  |                                      |
|----------------------------------|--------------------------------------|
| Historic Significance:           | Architecture/Engineering             |
| Architect, builder, or engineer: | Unknown                              |
| Architectural Style:             | No Style Listed                      |
| Area of Significance:            | Architecture                         |
| Period of Significance:          | 1750-1799                            |
| Owner:                           | <b>Private</b>                       |
| Historic Function:               | Domestic                             |
| Historic Sub-function:           | Secondary Structure, Single Dwelling |
| Current Function:                | Domestic                             |
| Current Sub-function:            | Secondary Structure, Single Dwelling |





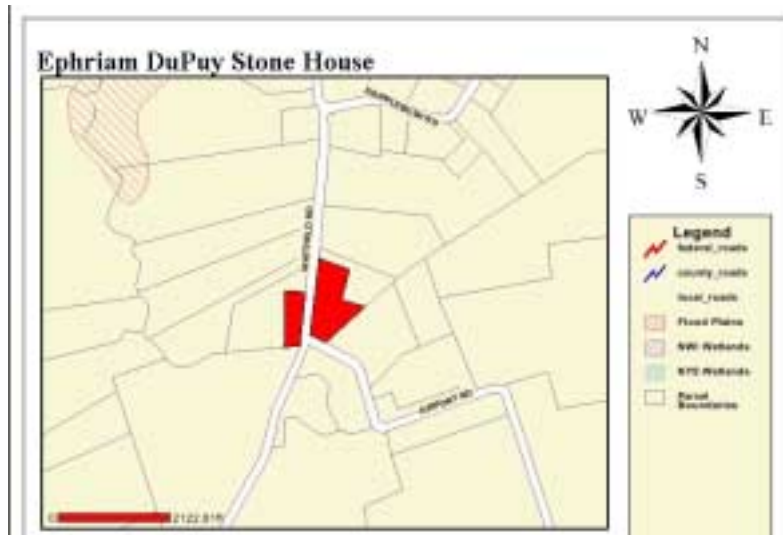

193 Whitfield Road  
 69.3-1-6.112  
 3.10 acres

**DuPuy, Ephriam, Stone House** (added 1995 - **Building** - #95000952)

193 Whitfield Rd., Rochester

|                         |                                      |
|-------------------------|--------------------------------------|
| Historic Significance:  | Architecture/Engineering             |
| Architectural Style:    | No Style Listed                      |
| Area of Significance:   | Architecture                         |
| Period of Significance: | 1750-1799, 1850-1874                 |
| Owner:                  | <b>Private</b>                       |
| Historic Function:      | Domestic                             |
| Historic Sub-function:  | Secondary Structure, Single Dwelling |
| Current Function:       | Domestic                             |
| Current Sub-function:   | Secondary Structure, Single Dwelling |



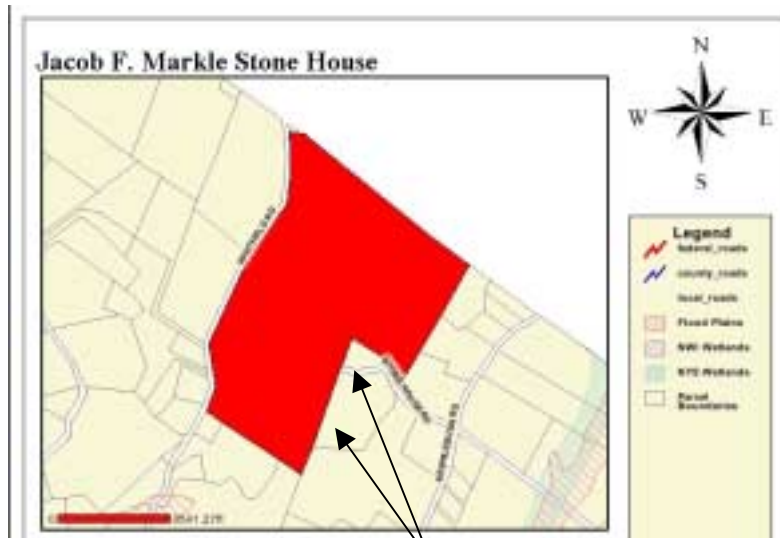

Common Ownership

335 Whitfield Road  
 69.1-1-3.100 & 69.1-2-48  
 91.7 acres & 11 acres

**Markle, Jacob F., Stone House** (added 1995 - **Building** - #95000948)

335 Whitfield Rd., Rochester

|                         |                                      |
|-------------------------|--------------------------------------|
| Historic Significance:  | Architecture/Engineering             |
| Architectural Style:    | No Style Listed                      |
| Area of Significance:   | Architecture                         |
| Period of Significance: | 1750-1799, 1875-1899                 |
| Owner:                  | <b>Private</b>                       |
| Historic Function:      | Domestic                             |
| Historic Sub-function:  | Secondary Structure, Single Dwelling |
| Current Function:       | Domestic                             |
| Current Sub-function:   | Secondary Structure, Single Dwelling |



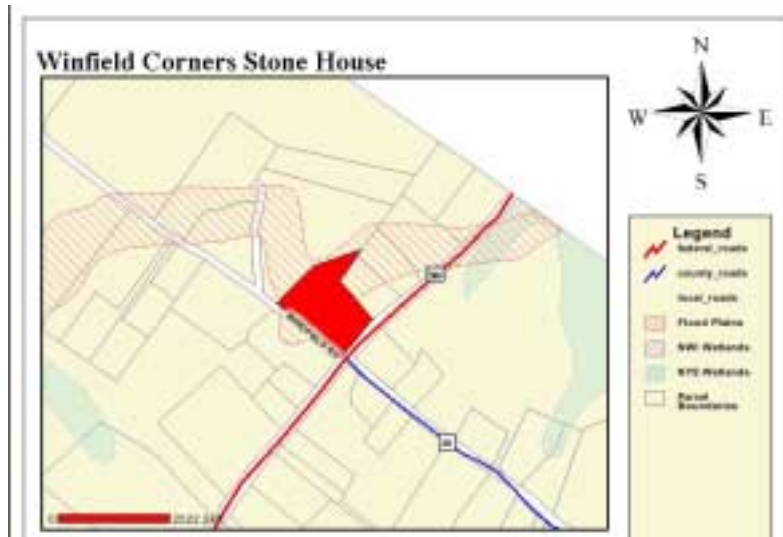

16 Winfield Road  
 69.3-2-6.200  
 5.74 acres

**Winfield Corners Stone House** (added 1999 - **Building** - #99000993)

Winfield Rd., Rochester

|                         |   |
|-------------------------|---|
| Historic Significance:  | Architecture/Engineering                              |
| Architectural Style:    | Colonial  |
| Area of Significance:   | Architecture  |
| Period of Significance: | 1700-1749, 1750-1799, 1800-1824, 1825-1849, 1850-1874 |
| Owner:                  | <b>Private</b>  |
| Historic Function:      | Domestic  |
| Historic Sub-function:  | Single Dwelling                                       |
| Current Function:       | Domestic  |
| Current Sub-function:   | Single Dwelling                                       |



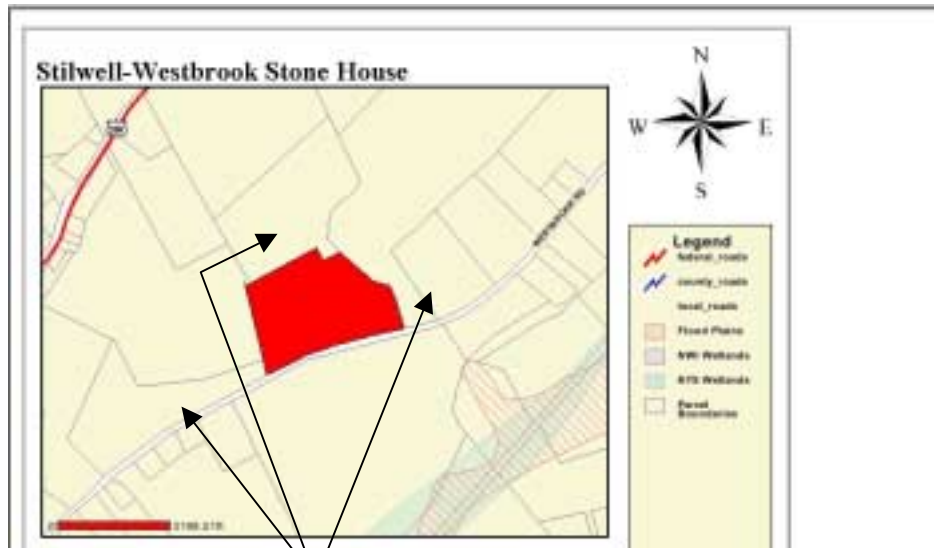

482 Old Kings Highway  
 69.3-3-23  
 20.51 acres

Common Ownership

**Stilwell--Westbrook Stone House** (added 1999 - **Building** - #99000997)

482 Old Kings Highway, Rochester

|                         |   |
|-------------------------|---|
| Historic Significance:  | Architecture/Engineering                              |
| Architectural Style:    | Colonial, Greek Revival                               |
| Area of Significance:   | Architecture  |
| Period of Significance: | 1750-1799, 1800-1824, 1825-1849, 1850-1874, 1875-1899 |
| Owner:                  | <b>Private</b>  |
| Historic Function:      | Domestic  |
| Historic Sub-function:  | Single Dwelling                                       |
| Current Function:       | Domestic  |
| Current Sub-function:   | Single Dwelling                                       |





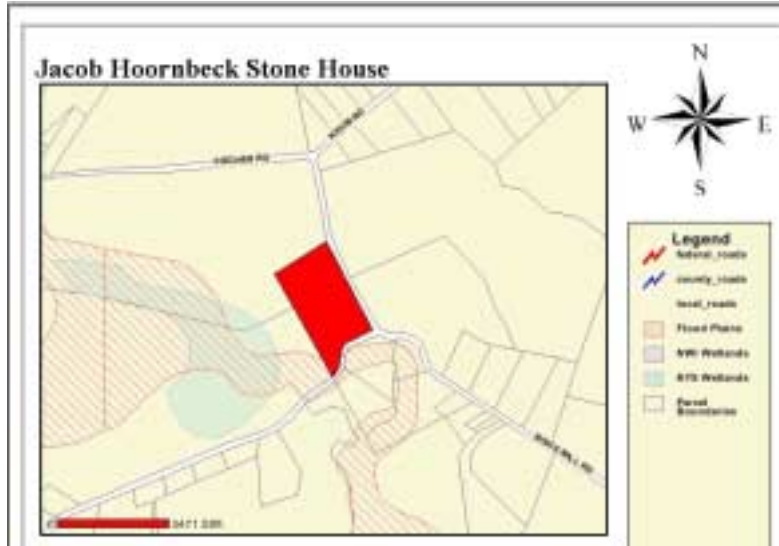

3 Dunn Farms Road  
 76.1-2-2.300  
 13.7 acres

**Hoornbeck, Jacob, Stone House** (added 1997 - **Building** - #97000108)  
 Boice Mill Rd., jct. with Krum Rd., Rochester  
 Historic Significance: Architecture/Engineering  
 Architectural Style: No Style Listed  
 Area of Significance: Architecture  
 Period of Significance: 1800-1824  
 Owner: **Private**  
 Historic Function: Domestic  
 Historic Sub-function: Single Dwelling  
 Current Function: Domestic  
 Current Sub-function: Single Dwelling



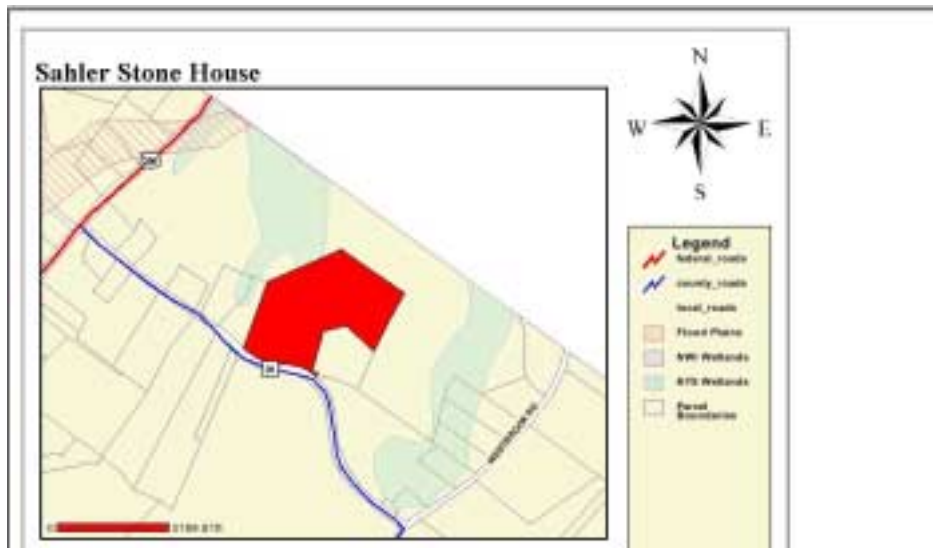

Kyserike Road (across from school)  
 69.4-2-2  
 20 acres

**Sahler Stone House** (added 1999 - **Building** - #99000992)

Kyserike Rd., Rochester

|                         |  |
|-------------------------|--|
| Historic Significance:  | Architecture/Engineering                   |
| Architectural Style:    | Colonial                                   |
| Area of Significance:   | Architecture                               |
| Period of Significance: | 1750-1799, 1800-1824, 1825-1849, 1850-1874 |
| Owner:                  | <b>Private</b>                             |
| Historic Function:      | Domestic                                   |
| Historic Sub-function:  | Single Dwelling                            |
| Current Function:       | Domestic                                   |
| Current Sub-function:   | Single Dwelling                            |





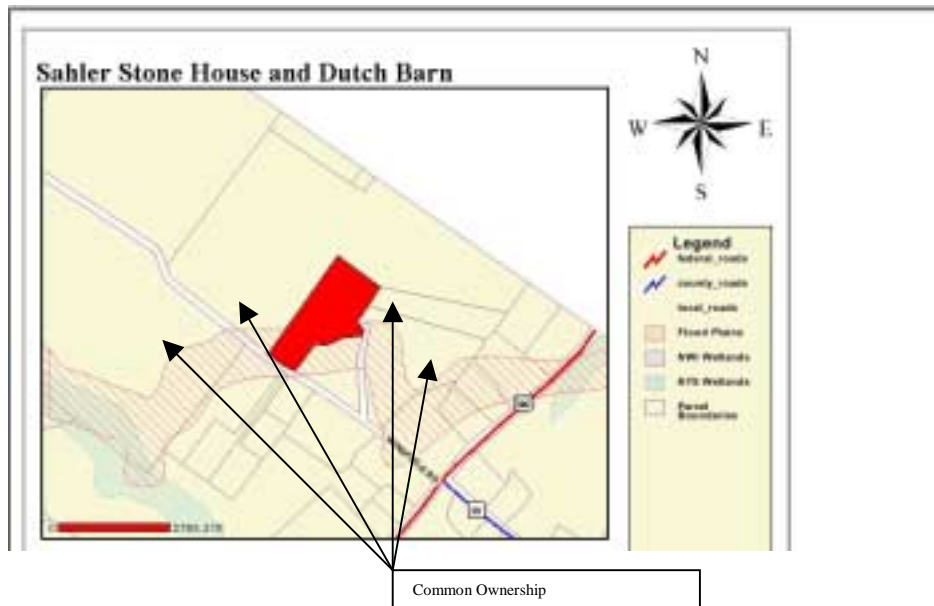

540 Winfield Corners  
 69.1-2-9 & 69.1-2-11 & 69.1-2-12.100 & 69.1-2-12.200  
 11.13 acres & 7 acres & 104.5 acres & 4 acres

**Sahler Stone House and Dutch Barn** (added 1999 - **Building** - #99000998)

Winfield Rd., Rochester

|                         |   |
|-------------------------|---|
| Historic Significance:  | Architecture/Engineering                  |
| Architectural Style:    | Colonial, Federal                         |
| Area of Significance:   | Architecture                              |
| Period of Significance: | 1750-1799, 1800-1824, 1825-1849           |
| Owner:                  | <b>Private</b>                            |
| Historic Function:      | Agriculture/Subsistence, Domestic         |
| Historic Sub-function:  | Animal Facility, Single Dwelling, Storage |
| Current Function:       | Agriculture/Subsistence, Domestic         |
| Current Sub-function:   | Animal Facility, Single Dwelling, Storage |



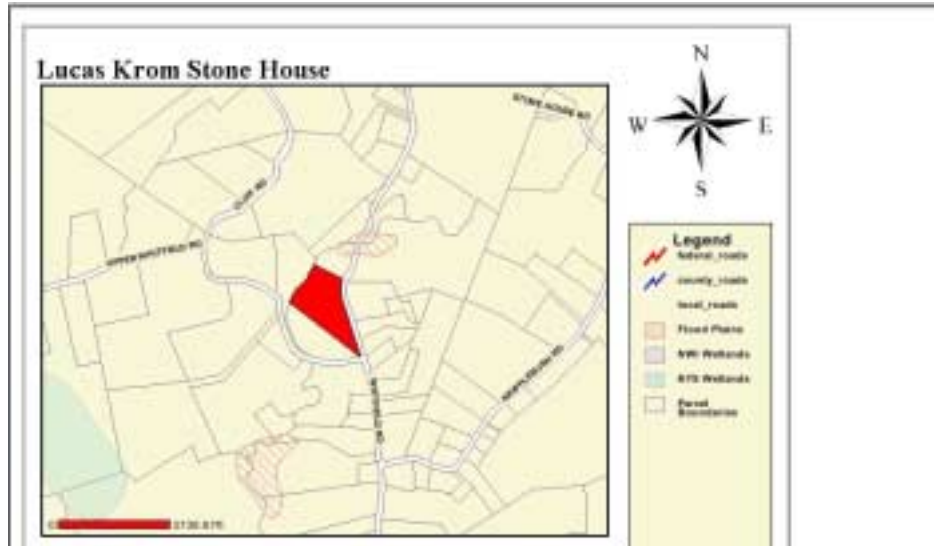

286 Whitfield Rd.  
 69.1-1-26.200  
 7.21 acres

**Krom, Lucas, Stone House** (added 1995 - **Building** - #95000953)

286 Whitfield Rd., Rochester

|                                  |                                      |
|----------------------------------|--------------------------------------|
| Historic Significance:           | Architecture/Engineering             |
| Architect, builder, or engineer: | Unknown                              |
| Architectural Style:             | No Style Listed                      |
| Area of Significance:            | Architecture                         |
| Period of Significance:          | 1750-1799, 1800-1824                 |
| Owner:                           | <b>Private</b>                       |
| Historic Function:               | Domestic                             |
| Historic Sub-function:           | Secondary Structure, Single Dwelling |
| Current Function:                | Domestic                             |
| Current Sub-function:            | Secondary Structure, Single Dwelling |



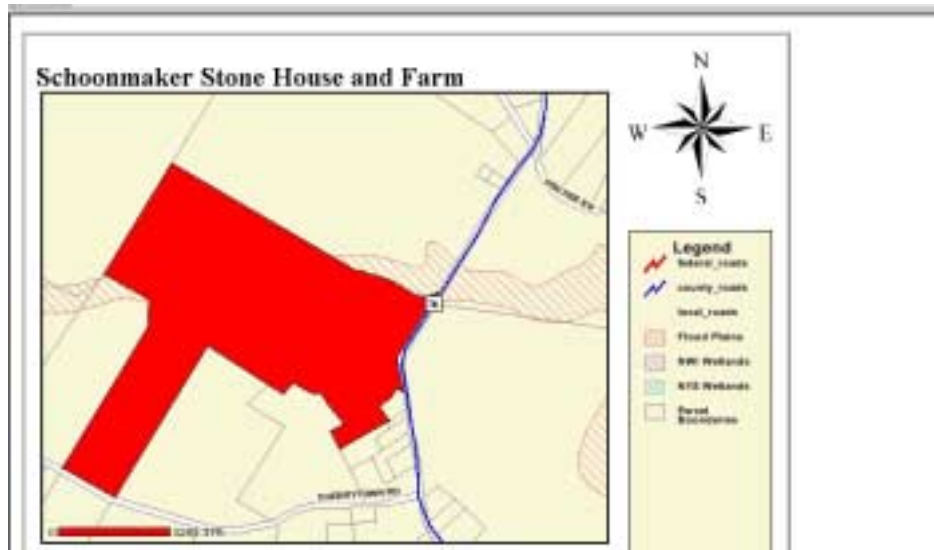

203 Samsonville Rd.  
 76.1-1-1  
 96 acres

**Schoonmaker Stone House and Farm** (added 1997 - **Building** - #97000109)  
 Samsonville Rd., near jct. of NY 76 and Cherrytown Rd., Rochester  
 Historic Significance: Architecture/Engineering  
 Architectural Style: Federal  
 Area of Significance: Architecture  
 Period of Significance: 1800-1824, 1825-1849, 1850-1874, 1875-1899  
 Owner: **Private**  
 Historic Function: Agriculture/Subsistence, Domestic  
 Historic Sub-function: Agricultural Outbuildings, Single Dwelling  
 Current Function: Agriculture/Subsistence, Domestic  
 Current Sub-function: Agricultural Outbuildings, Single Dwelling







90 Upper Whitfield Rd  
68.4-3-13

**Barley, Zachariah, Stone House** (added 1995 - **Building** - #95000951)  
 193 Whitfield Rd., Rochester (incorrect address on National Register)  
 Historic Significance: Architecture/Engineering  
 Architectural Style: No Style Listed  
 Area of Significance: Architecture  
 Period of Significance: 1750-1799, 1850-1874, 1875-1899  
 Owner: **Private**  
 Historic Function: Domestic  
 Historic Sub-function: Secondary Structure, Single Dwelling  
 Current Function: Domestic  
 Current Sub-function: Secondary Structure, Single Dwelling



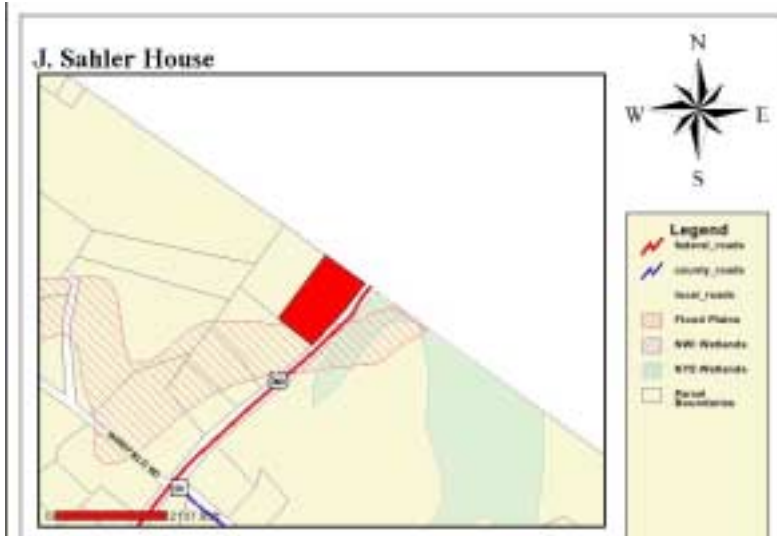

4496 Route 209  
 69.4-2-1.320  
 2.9 acres

**Sahler, J., House** (added 2000 - **Building** - #97000118)

Also known as **Elm Rock**

NY 209, SW of jct. with Co. Rd. 63, Rochester

|                         |  |
|-------------------------|--|
| Historic Significance:  | Architecture/Engineering                   |
| Architectural Style:    | Federal                                    |
| Area of Significance:   | Architecture                               |
| Period of Significance: | 1800-1824, 1825-1849, 1850-1874, 1875-1899 |
| Owner:                  | <b>Private</b>                             |
| Historic Function:      | Domestic                                   |
| Historic Sub-function:  | Single Dwelling                            |
| Current Function:       | Domestic                                   |
| Current Sub-function:   | Single Dwelling                            |



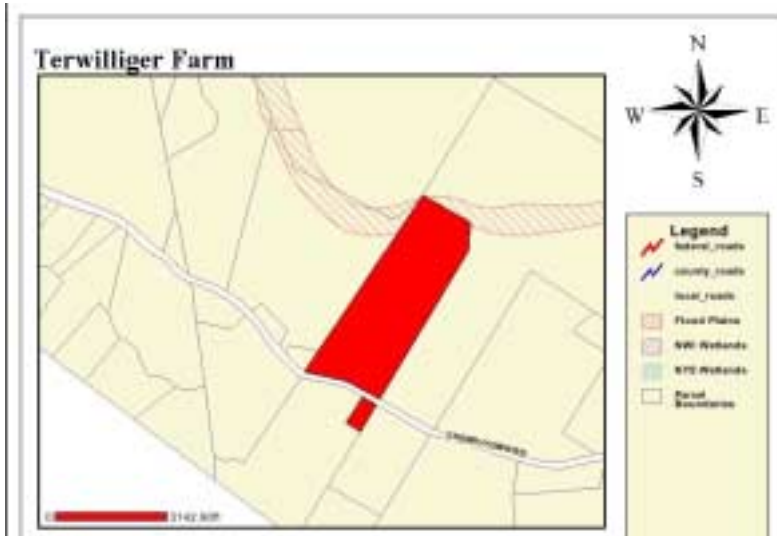

Terwilliger-Smith Farm  
 160 Cherrytown Road  
 76.1-1-21  
 21.3 acres





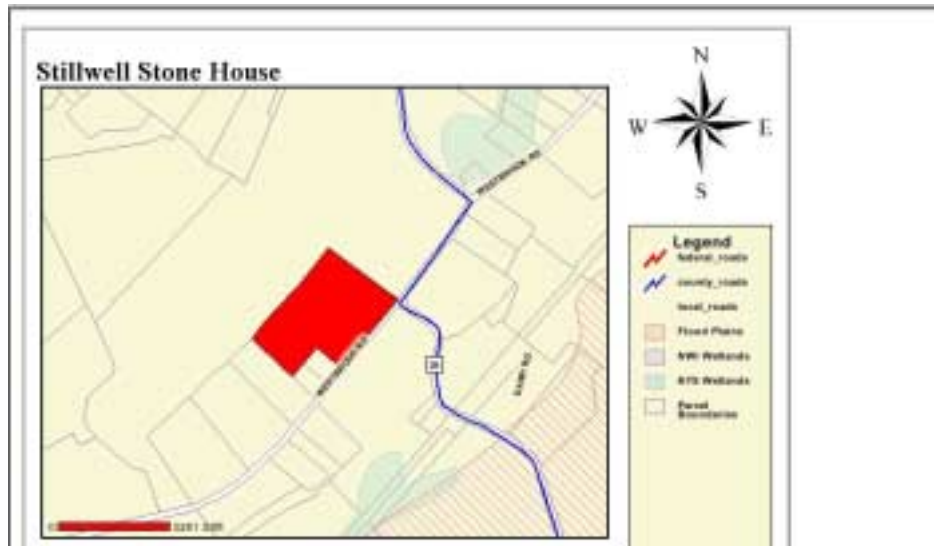

69.3-3-18  
 412 Old Kings Highway (Westbrook Rd.) (Formerly 189 Old Kings Hwy)  
 17.5 acres

**Stillwell Stone House** (added 1999 - **Building** - #99000996)

189 Old Kings Highway, Rochester

|                         |  |
|-------------------------|--|
| Historic Significance:  | Architecture/Engineering                   |
| Architectural Style:    | Federal                                    |
| Area of Significance:   | Architecture                               |
| Period of Significance: | 1750-1799, 1800-1824, 1825-1849, 1850-1874 |
| Owner:                  | <b>Private</b>                             |
| Historic Function:      | Agriculture/Subsistence, Domestic          |
| Historic Sub-function:  | Animal Facility, Single Dwelling, Storage  |
| Current Function:       | Agriculture/Subsistence, Domestic          |
| Current Sub-function:   | Animal Facility, Single Dwelling, Storage  |



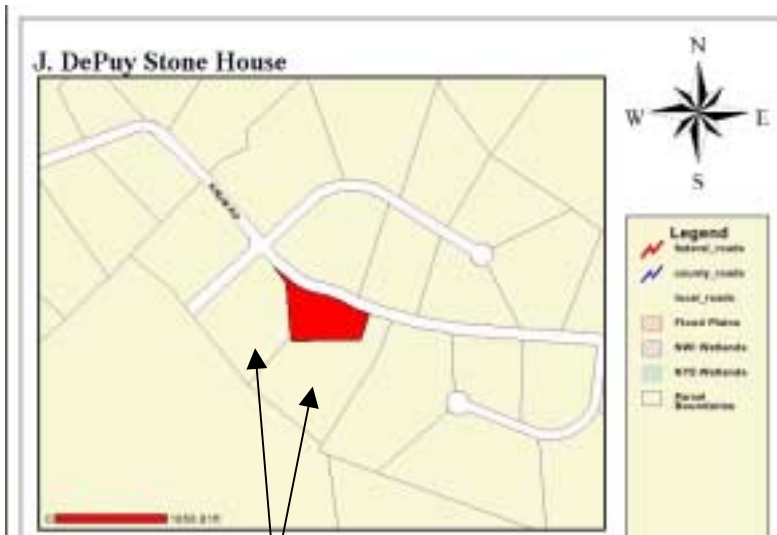

68.3-5-14  
200 Krum Road  
2.39 Acres

Under Common Ownership

Also owns 68.3-5-13  
68.3-5-15

**Dupuy, J., Stone House** (added 1997 - **Building** - #97000110)  
Krum Rd., W of jct. with Queens Hwy., Rochester  
Historic Significance: Architecture/Engineering  
Architectural Style: No Style Listed  
Area of Significance: Architecture  
Period of Significance: 1825-1849  
Owner: **Private**  
Historic Function: Domestic  
Historic Sub-function: Single Dwelling  
Current Function: Domestic  
Current Sub-function: Single Dwelling



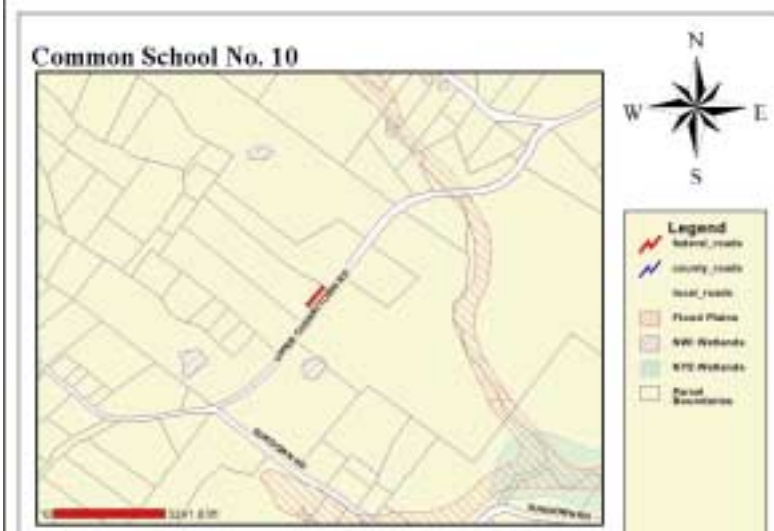

Town of Rochester  
 59.8-1-11  
 In front of 190 Palentown Road

**Common School No. 10** (added 1988 - **Building** - #88001439)

Northside of Upper Cherrytown Rd., Accord

Historic Significance:

Architect, builder, or engineer:

Architectural Style:

Area of Significance:

Period of Significance:

Owner:

Historic Function:

Historic Sub-function:

Current Function:

Event, Architecture/Engineering

Dymond, Horace

No Style Listed

Education, Architecture

1850-1874

**Local Gov't**

Domestic, Education

School, Secondary Structure

Government

